

For Immediate Release: May 23, 2012

Contact: Sarah L. Stifler, Hammer Communications, 310-443-7056, sstifler@hammer.ucla.edu

MADE IN L.A. 2012 OPENS JUNE 2

Los Angeles biennial features nearly all new work by 60 artists

Los Angeles—*Made in L.A. 2012*, the first in an ongoing series of biennial exhibitions focused on new work created by artists in the Los Angeles region, opens June 2 at the **Hammer Museum, LA><ART** in Culver City, and the **Los Angeles Municipal Art Gallery** at Barnsdall Park in Los Feliz. Building upon the tradition of Hammer Invitational exhibitions, *Made in L.A. 2012* features work by 60 artists with an emphasis on emerging and under-recognized artists. This exhibition will debut nearly all new installations, performances, drawings, film, video, sculptures, and paintings created specifically for *Made in L.A. 2012*. There are ten major new commissions for the exhibition and, in contrast to most biennials, every artist has received an honorarium.

Made in L.A. 2012, on view through September 2, 2012, is organized by a team of curators from the Hammer and LA><ART: Hammer Senior Curator Anne Ellegood, Hammer curator Ali Subotnick, LA><ART Director and Chief Curator Lauri Firstenberg, LA><ART Associate Director and Senior Curator Cesar Garcia, and LA><ART curator-at-large Malik Gaines.

NEW WEBSITE: MADEINLA2012.ORG

The Hammer Museum has just launched a dedicated website for the biennial—MADEINLA2012.ORG—which includes videos, a blog, robust content about each of the artists, and details on all public programs and performances at each of the venues.

BILLBOARD PROJECTS

Artists from *Made in L.A. 2012* will produce billboard projects in various locations around the city; reaching broad audiences while complementing the installations at LA><ART and the Los Angeles Municipal Gallery at Barnsdall Park. With support from CBS Outdoor and the City of West Hollywood Art on the Outside program.

La Cienega Blvd. between Venice and Washington Blvds. (facing north):

June: Slanguage **July:** Roy Dowell **August:** Meg Cranston

Hollywood Blvd. at the entrance of Barnsdall Park:

July/August: Nicole Miller **August/September:** Cayetano Ferrer

Sunset Blvd. (At Olive Drive in West Hollywood):

Dashiell Manley

FREE iPhone APP: Made in L.A. Soundmap

Made in L.A. Soundmap is a site-specific mobile audio experience designed for use while traveling to, from, and in between the three biennial venues. *Made in L.A. Soundmap* explores Los Angeles as the context for the exhibition through interviews with *Made in L.A. 2012* artists and curators. In a first-of-

its kind usage of geolocate technologies, audio segments from these interviews are placed throughout a city map, with each location relating specifically to the segment content. Audio segments play automatically as the app user moves through the city, responding to the user's specific location. In between segments, music curated by the local collective **dublabb** creates a soundtrack for one's journey through L.A. Made in L.A. Soundmap is a free iPhone app that will be available in the iTunes store by June 2.

PUBLIC PROGRAMS & PERFORMANCES

Made in L.A. 2012 will be accompanied by a robust schedule of free public programs, including live performances, film screenings, a music series presented with KCRW, conversations among participating artists, and curator walkthroughs. Download a pdf guide to public programs and performances at MADEINLA2012.org.

THE MOHN AWARD

The Mohn Award is presented in conjunction with *Made in L.A. 2012*. Funded through the generosity of Los Angeles philanthropists and art collectors Jarl and Pamela Mohn, the \$100,000 award will be distributed over two years to an artist from the exhibition and will be accompanied by the publication of a book on the finalist's work. All 60 artists at all three *Made in L.A. 2012* venues are eligible to win the Mohn Award. The Mohn Award follows in the tradition of the Tate's Turner Prize and the Whitney Museum of American Art's Bucksbaum Award. It is different in one significant way, however: while a professional jury will select five finalists from among the 60 artists, the Mohn Award recipient will be chosen by visitors to the exhibition through online and on-site voting. **The five finalists will be announced on June 28 at a Hammer Bash!**—a public event celebrating the exhibition—and voting will commence immediately. All visitors who wish to vote must register onsite at either the Hammer Museum or the Los Angeles Municipal Art Gallery (a photo ID will be required). Votes may be cast onsite or online at MADEINLA2012.ORG. Voting ends August 12 and the finalist will be announced soon after.

VENICE BEACH BIENNIAL

July 13-15, 2012

The *Venice Beach Biennial* (VBB), a weekend event that makes tongue-in-cheek reference to the "real" Venice Biennale in Italy, treats the famed Venice Beach boardwalk, Ocean Front Walk, as an outdoor exhibition venue. Over the course of the weekend of July 13-15, over 30 fine artists will set up vending stands alongside the veteran boardwalk artists, exhibiting new bodies of work, collaborating with the veterans on new projects, displaying site-specific sculptures or installations, and presenting live performances. VBB is presented in conjunction with *Made in L.A. 2012* and directed by Hammer curator Ali Subotnick.

CATALOGUE

Made in L.A. 2012 is accompanied by a lavish hardcover catalogue that includes an essay with contributions from each of the curators, a text about each of the sixty artists, and more than 300 full-color images of the artists' works. The catalogue is designed by Michael Worthington of Counterspace, a Los Angeles-based design studio, and the type is set in "Raisonné," a new font designed by Benjamin Critton. The catalogue is co-published with DelMonico Books, an imprint of Prestel Publishing, and retails for \$49.95.

ARTISTS IN MADE IN L.A. 2012

Scoli Acosta
Kathryn Andrews
Animal Charm (Richard Bott & Jim Fetterley)
Math Bass
Scott Benzel
Sarah Cain
Sarah Conaway
Fiona Connor
Kate Costello
Meg Cranston
Nzuji de Magalhães
Michelle Dizon
Roy Dowell
Zackary Drucker (In collaboration with Rhys Ernst)
Patricia Fernández
Cayetano Ferrer
Dan Finsel
Morgan Fisher
Simone Forti
Liz Glynn
Mark Hagen
Zach Harris
Kenyatta A. C. Hinkle
Channa Horwitz
Pearl C. Hsiung
Ashley Hunt
Vishal Jugdeo
Mimi Lauter
Thomas Lawson
Nery Gabriel Lemus
Dashiell Manley
Allison Miller
Nicole Miller
Meleko Mokgosi
Zac Monday
Ruby Neri
D'Ette Nogle
Alex Olson
Michele O'Marah
Camilo Ontiveros
Joel Otterson
Karthik Pandian
The Propeller Group (Phunam Thuc Ha, Matt Lucero & Tuan Andrew Nguyen)
Vincent Ramos
Laura Riboli
Ry Rocklen
Miljohn Ruperto
Analia Saban
Brian Sharp
Slanguage (Mario Ybarra Jr. & Karla Diaz)
Ryan Sluggett
David Snyder
Jill Spector
Koki Tanaka
Henry Taylor
Caroline Thomas
Cody Trepte
Erika Vogt
Lisa Williamson
Brenna Youngblood

Made in L.A. 2012 is organized by the Hammer Museum in collaboration with LA><ART.

The exhibition is presented by



Major support is provided by the Annenberg Foundation; the City of Los Angeles Department of Cultural Affairs; Fundación Jumex, A.C.; Kayne Foundation—Ric & Suzanne Kayne and Jenni, Maggie & Saree; The Mohn Family Foundation; and the members of the Hammer Circle.

The Venice Beach Biennial is made possible by the Teiger Foundation.

Generous support is also provided by the National Endowment for the Arts; the Bloom Family; Gail and Stanley Hollander; Linda and Jerry Janger; Dori Peterman Mostov and Charles Mostov; Karyn Kohl; Heidi and Erik Murkoff; Julie and Barry Smooke; Amy Adelson and Dean Valentine; The Fran and Ray Stark Foundation; and an anonymous donor.

Additional support is provided by the Pasadena Art Alliance; Alumnos 47; ForYourArt; and the LA><ART Producers Council.

KCRW 89.9 FM is the official radio sponsor. *Los Angeles* magazine is the official print sponsor. Special thanks to American Apparel.



ABOUT THE HAMMER MUSEUM

The Hammer Museum, a public arts unit of the University of California, Los Angeles, is dedicated to exploring the diversity of artistic expression through the ages. Its collections, exhibitions, and programs span the classic to the cutting-edge in art, architecture, and design, recognizing that artists play a crucial role in all aspects of culture and society.

The museum houses the Armand Hammer Collection of Old Master, Impressionist, and Post-Impressionist paintings and the Armand Hammer Daumier and Contemporaries Collection. The museum also houses the Grunwald Center for the Graphic Arts, comprising more than 45,000 prints, drawings, photographs, and artists' books from the Renaissance to the present; and oversees the management of the Franklin D. Murphy Sculpture Garden on the UCLA campus. The Hammer's newest collection, the Hammer Contemporary Collection, is highlighted by works by artists such as Lari Pittman, Kara Walker, Ed Ruscha, Barbara Kruger, Mark Bradford, Richard Hawkins, Lynn Foulkes, among many others.

The Hammer presents major single-artist and thematic exhibitions of historical and contemporary art. It also presents approximately ten Hammer Projects exhibitions each year, providing international and local artists with a laboratory-like environment to create new work or to present existing work in a new context.

As a cultural center, the Hammer offers a diverse range of free public programs throughout the year, including lectures, readings, symposia, film screenings, and music performances. The Hammer's Billy Wilder Theater houses these widely acclaimed public programs and is the new home of the UCLA Film & Television Archive's renowned cinematheque.

HAMMER MUSEUM INFORMATION

For current program and exhibition information call **310-443-7000** or visit **www.hammer.ucla.edu**.

Hours: Tuesday–Friday 11am–8pm; Saturday & Sunday 11am–5pm; closed Mondays, July 4, Thanksgiving, Christmas, and New Year’s Day.

Admission: \$10 for adults; \$5 for seniors (65+) and UCLA Alumni Association members; free for Museum members, students with identification, UCLA faculty/staff, military personnel, veterans, and visitors 17 and under. The Museum is free on Thursdays for all visitors. Public programs are always free.

Location/Parking: The Hammer is located at 10899 Wilshire Boulevard, at Westwood Boulevard. Parking is available under the Museum. Rate is \$3 for three hours with Museum validation. Bicycles park free.

Hammer Museum Tours: For group tour reservations and information, call 310-443-7041.

ABOUT LA><ART

Founded in 2005, LA><ART is a leading independent nonprofit contemporary art space in Los Angeles, committed to the production of experimental exhibitions and public art initiatives. Responding to Los Angeles’ cultural climate, LA><ART produces and presents new work for all audiences and offers the public access to the next generation of artists and curators. LA><ART supports challenging work, reflecting the diversity of the city and stimulates conversations on contemporary art in Los Angeles, fostering dynamic relationships between art, artists and their audiences. LA><ART produced and commissioned over 100 projects in its first five years.

In 2012, LA><ART will launch its vision campaign including *The Occasional* – a city wide exhibition and public art initiative. This platform for L.A. continues the organization’s ongoing commitment to supporting artistic and curatorial freedom while focusing on commissioning new work in experimental contexts.

LA><ART INFORMATION

For current exhibition and event information, please call **310-559-0166** or visit **www.laxart.org**.

Hours: Tuesday through Saturday, 11am – 6pm.

Location: LA><ART is located at 2640 S. La Cienega Boulevard.

For Immediate Release: March 14, 2012

Contact: Sarah L. Stifler, Hammer Communications, 310-443-7056, stifler@hammer.ucla.edu

**THE HAMMER MUSEUM AND LA><ART ANNOUNCE ARTISTS FOR *MADE IN L.A. 2012*
Los Angeles biennial will feature sixty emerging and under-recognized artists**

Los Angeles—The Hammer Museum and LA><ART are pleased to announce the artists participating in the upcoming *Made in L.A. 2012*, the first in an ongoing series of biennial exhibitions focused on new work created by artists in the Los Angeles region. *Made in L.A. 2012*, organized by the Hammer Museum in collaboration with LA><ART, will be presented at the Hammer Museum, LA><ART in Culver City, and the Department of Cultural Affairs' Los Angeles Municipal Art Gallery at Barnsdall Park from **June 2–September 2, 2012**. Building upon the tradition of Hammer Invitational exhibitions, *Made in L.A. 2012* will feature sixty artists with an emphasis on emerging and under-recognized artists. In addition to painting, installation, video, and sculpture, *Made in L.A. 2012* features six performance artists whose work will be performed at both the Hammer and the Los Angeles Municipal Art Gallery (LAMAG). The exhibition will include a full roster of public programming as well as a comprehensive hardcover catalogue.

"For over a decade, every two years, the Hammer has mounted an Invitational exhibition: *Snapshot*, *International Paper*, *Thing*, *Nine Lives*, and most recently *All of this and nothing*. These shows, with a few exceptions, focused primarily on artists from L.A. With *Made in L.A.* what we are essentially doing is clarifying this pattern and calling it what it is—a biennial—a word that everyone seems to understand," remarks Hammer Director Annie Philbin. "Our decision to focus exclusively on L.A. artists reinforces our ongoing commitment to the creative community that makes this city so vibrant."

Made in L.A. 2012 is organized by a team of curators from the Hammer and LA><ART: Hammer Senior Curator **Anne Ellegood**, Hammer curator **Ali Subotnick**, LA><ART Director and Chief Curator **Lauri Firstenberg**, LA><ART Associate Director and Senior Curator **Cesar Garcia**, and LA><ART curator-at-large **Malik Gaines**. These curators have been working together for over 16 months, visiting hundreds of studios and galleries and meeting regularly to review and narrow down their selections to artists that they unanimously agreed to include. Out of those studio visits and curatorial meetings certain threads and preoccupations connecting the artists began to emerge which guided the organization of the exhibition.

"Working with this curatorial team has been a gift and a highlight of this project. Our process was one of dynamic discussion and negotiation and our disparate approaches and priorities created a heterogeneous methodology to researching cultural production in L.A. at this moment," explains LA><ART Director Lauri Firstenberg. "The loose concepts of archeology, materiality, theatricality, subjectivity, and mythology rose to the surface in our curatorial sessions as threads for establishing relationships between the works. Though the installation is not explicitly organized around these ideas, they are certainly explored in the catalogue."

This exhibition will debut nearly all new installations, videos, films, sculptures, performances, drawings, and paintings created specifically for *Made in L.A. 2012*. There are ten major new commissions for the exhibition and, in contrast to most biennials, every artist has received an honorarium. In conjunction with *Made in L.A. 2012* curator Ali Subotnick is also organizing the **Venice Beach Biennial** on **July 13–15, 2012**. This special weekend event highlights the often unconventional and irreverent nature of L.A.'s art scene. Altogether, *Made in L.A. 2012* and its accompanying programs, events, and catalogue will offer a snapshot of the current trends and practices coming out of Los Angeles, one of the most active and energetic art communities in the world.

ARTISTS AT THE HAMMER MUSEUM

Made in L.A. 2012 will take place in every gallery at the Museum except for the Armand Hammer Collection galleries. Works by **thirty-seven** artists will be on view at the Hammer: Scoli Acosta, Kathryn Andrews, Sarah Conaway, Fiona Connor, Kate Costello, Meg Cranston, Roy Dowell, Zackary Drucker in collaboration with Rhys Ernst, Patricia Fernández, Dan Finsel, Morgan Fisher, Liz Glynn, Mark Hagen, Zach Harris, Channa Horowitz, Pearl Hsiung, Vishal Jugdeo, Mimi Lauter, Thomas Lawson, Meleko Mokgosi, Ruby Neri, D'Ette Nogle, Alex Olson, Camilo Ontiveros, Joel Otterson, Karthik Pandian, Laura Riboli, Analia Saban, Brian Sharp, Ryan Sluggett, David Snyder, Jill Spector, Koki Tanaka, Caroline Thomas, Cody Trepte, Erika Vogt, and Lisa Williamson.

ARTISTS AT THE LOS ANGELES MUNICIPAL ART GALLERY AT BARNSDALL PARK

Work by **sixteen** artists will be on view throughout the 10,000 square foot space at the Los Angeles Municipal Art Gallery (LAMAG): Animal Charm (Rich Bott and Jim Fetterley), Sarah Cain, Michelle Dizon, Cayetano Ferrer, Simone Forti, Nery Gabriel Lemus, Dashiell Manley, Allison Miller, Nicole Miller, Michele O'Marah, The Propeller Group (Phunam Thuc Ha, Matt Lucero, and Tuan Andrew Nguyen), Vincent Ramos, Ry Rocklen, Miljohn Ruperto, Henry Taylor, and Brenna Youngblood.

ARTISTS AT LA><ART

The space at LA><ART will be activated by the collective Slanguage, founded by Los Angeles-based artists Karla Diaz and Mario Ybarra Jr. The three-month-long project *This Is a Takeover! A Ten-Year Survey of Slanguage* will include an installation in LA><ART's main gallery, a site-specific mural on the space's facade, a newly commissioned public billboard project on La Cienega Boulevard, and a series of public programs intended to engage diverse publics.

PERFORMANCE ARTISTS

Made in L.A. 2012 will also feature works by **six** performance artists: Math Bass (Hammer); Scott Benzel (Hammer); Kenyatta A. C. Hinkle (Hammer & LAMAG); Ashley Hunt (Hammer & LAMAG); Nzuji de Magalhães (Hammer); and Zac Monday (Hammer & LAMAG). These artists will not have works on view in the galleries.

VENICE BEACH BIENNIAL

July 13-15, 2012

The Venice Beach Biennial (VBB), a weekend event that makes tongue-in-cheek reference to the "real" Venice Biennale in Italy, treats the famed Venice Beach boardwalk, Ocean Front Walk, as an outdoor exhibition venue. Over the course of the weekend, some 25 to 30 artists will set up vending stands alongside the veteran boardwalk artists, exhibiting new bodies of work, collaborating with the veterans on new projects, displaying site-specific sculptures or installations, and presenting live

performances. Presented in conjunction with *Made in L.A. 2012* and directed by Hammer curator Ali Subotnick.

PUBLIC PROGRAMS AND PUBLIC ENGAGEMENT

Made in L.A. 2012 will be accompanied by a robust schedule of free public programs, including live performances by Animal Charm and Simone Forti; film screenings with Zackary Drucker and Erika Vogt; a music series, conversations among participating artists, and student events. The Hammer's Public Engagement department is working with Fiona Connor, Zac Monday, D'Ette Nogle, and Koki Tanaka to produce their projects, as their works all include a public component or interaction with museum visitors.

BILLBOARD PROJECTS

Artists from *Made in L.A. 2012* will produce billboard projects in various locations around the city including spots complementing the installations at LA><ART and the Los Angeles Municipal Gallery at Barnsdall Park.

Billboard on La Cienega between Venice and Washington Blvds. facing LA><ART's facade:

June – Slanguage

July – Roy Dowell

August – Meg Cranston

Billboard on Hollywood Blvd. at the entrance of Barnsdall Park:

July/August – Nicole Miller

August/September – Cayetano Ferrer

Billboard on Sunset Blvd. at Olive in West Hollywood:

The Propeller Group

**With support from CBS Outdoor and the City of West Hollywood Art on the Outside program.

CATALOGUE

Made in L.A. 2012 is accompanied by a handsome hardcover catalogue that includes an essay with contributions from each of the curators, a text about each of the sixty artists, and more than 300 full-color images of the artists' work. The catalogue is designed by Michael Worthington of Counterspace, a Los Angeles-based design studio, and the type is set in "Raisonné," a new font designed by Benjamin Critton. The catalogue is co-published with DelMonico Books, an imprint of Prestel Publishing, and retails for \$49.95.

WELLS FARGO

The Hammer is also pleased to have Wells Fargo on board as *Made in L.A. 2012*'s Presenting Sponsor, an important and substantial commitment to this inaugural citywide event. "Wells Fargo has a long tradition of supporting arts and culture in Southern California and we have long admired the innovative work of Ann Philbin and her team at the Hammer Museum," remarks Tim Hanlon, President, Wells Fargo Foundation. "The museum's focus on artists from California, and Los Angeles in particular, is the kind of pride-of-place and investment in the cultural capital of our local community that resonates well with our commitments at Wells Fargo. We are thrilled to be the Presenting Sponsor of *Made in L.A. 2012* and proud to partner with the Hammer on this ambitious endeavor."

Made in L.A. 2012 is organized by the Hammer Museum in collaboration with LA><ART.

The exhibition is presented by



Major support is provided by the Annenberg Foundation; the City of Los Angeles Department of Cultural Affairs; Fundación Jumex, A.C.; Kayne Foundation—Ric & Suzanne Kayne and Jenni, Maggie & Saree; The Mohn Family Foundation; and the members of the Hammer Circle.

The Venice Beach Biennial is made possible by the Teiger Foundation.

Generous support is also provided by the National Endowment for the Arts; the Bloom Family; Gail and Stanley Hollander; Linda and Jerry Janger; Dori Peterman Mostov and Charles Mostov; Karyn Kohl; Heidi and Erik Murkoff; Julie and Barry Smooke; Amy Adelson and Dean Valentine; The Fran and Ray Stark Foundation; and an anonymous donor.

Additional support is provided by the Pasadena Art Alliance; Alumnos 47; ForYourArt; and the LA><ART Producers Council.

KCRW 89.9 FM is the official radio sponsor. *Los Angeles* magazine is the official print sponsor. Special thanks to American Apparel.



ABOUT THE HAMMER MUSEUM

The Hammer Museum, a public arts unit of the University of California, Los Angeles, is dedicated to exploring the diversity of artistic expression through the ages. Its collections, exhibitions, and programs span the classic to the cutting-edge in art, architecture, and design, recognizing that artists play a crucial role in all aspects of culture and society.

The museum houses the Armand Hammer Collection of Old Master, Impressionist, and Post-Impressionist paintings and the Armand Hammer Daumier and Contemporaries Collection. The museum also houses the Grunwald Center for the Graphic Arts, comprising more than 45,000 prints, drawings, photographs, and artists' books from the Renaissance to the present; and oversees the management of the Franklin D. Murphy Sculpture Garden on the UCLA campus. The Hammer's newest collection, the Hammer Contemporary Collection, is highlighted by works by artists such as Lari Pittman, Kara Walker, Ed Ruscha, Barbara Kruger, Mark Bradford, Richard Hawkins, Lynn Foulkes, among many others.

The Hammer presents major single-artist and thematic exhibitions of historical and contemporary art. It also presents approximately ten Hammer Projects exhibitions each year, providing international and local artists with a laboratory-like environment to create new work or to present existing work in a new context.

As a cultural center, the Hammer offers a diverse range of free public programs throughout the year, including lectures, readings, symposia, film screenings, and music performances. The Hammer's Billy Wilder Theater houses these widely acclaimed public programs and is the new home of the UCLA Film & Television Archive's renowned cinematheque.

HAMMER MUSEUM INFORMATION

For current program and exhibition information call **310-443-7000** or visit **www.hammer.ucla.edu**.

Hours: Tuesday–Friday 11am–8pm; Saturday & Sunday 11am – 5 pm; closed Mondays, July 4, Thanksgiving, Christmas, and New Year’s Day.

Admission: \$10 for adults; \$5 for seniors (65+) and UCLA Alumni Association members; free for Museum members, students with identification, UCLA faculty/staff, military personnel, veterans, and visitors 17 and under. The Museum is free on Thursdays for all visitors. Public programs are always free.

Location/Parking: The Hammer is located at 10899 Wilshire Boulevard, at Westwood Boulevard. Parking is available under the Museum. Rate is \$3 for three hours with Museum validation. Bicycles park free.

Hammer Museum Tours: For group tour reservations and information, call 310-443-7041.

ABOUT LA><ART

Founded in 2005, LA><ART is a leading independent nonprofit contemporary art space in Los Angeles, committed to the production of experimental exhibitions and public art initiatives. Responding to Los Angeles’ cultural climate, LA><ART produces and presents new work for all audiences and offers the public access to the next generation of artists and curators. LA><ART supports challenging work, reflecting the diversity of the city and stimulates conversations on contemporary art in Los Angeles, fostering dynamic relationships between art, artists and their audiences. LA><ART produced and commissioned over 100 projects in its first five years.

In 2012, LA><ART will launch its vision campaign including *The Occasional* – a city wide exhibition and public art initiative. This platform for L.A. continues the organization’s ongoing commitment to supporting artistic and curatorial freedom while focusing on commissioning new work in experimental contexts.

LA><ART INFORMATION

For current exhibition and event information, please call **310-559-0166** or visit **www.laxart.org**.

Hours: Tuesday through Saturday, 11am – 6pm.

Location: LA><ART is located at 2640 S. La Cienega Boulevard.

For Immediate Release: March 14, 2012

Contact: Sarah L. Stifler, Hammer Communications, 310-443-7056, sstifler@hammer.ucla.edu

**THE HAMMER MUSEUM TO PRESENT
THE MOHN AWARD DURING *MADE IN L.A. 2012*
A professional jury and the public will select one artist to receive this \$100,000 award**

Los Angeles—The Hammer Museum is pleased to announce the establishment of the Mohn Award in conjunction with the inauguration of *Made in L.A. 2012*, the Hammer's biennial exhibition highlighting emerging and overlooked artists from the Los Angeles region. *Made in L.A. 2012* features 60 artists and three venues throughout the city: the Hammer Museum in Westwood, the Department of Cultural Affairs' Los Angeles Municipal Art Gallery at Barnsdall Park in Los Feliz, and LA><ART in Culver City. Funded through the generosity of Los Angeles philanthropists and art collectors **Jarl and Pamela Mohn**, the \$100,000 award will be granted over two years to an artist from the exhibition and will be accompanied by the publication of a book on the finalist's work. The Mohn Award follows in the tradition of the Tate's Turner Prize and the Whitney Museum of American Art's Bucksbaum Award. However it is differentiated in one significant way: while a jury of professional curators will select five finalists from among the 60 artists, the Mohn Award recipient will be chosen by visitors to the exhibition through online and on-site voting.

Shining a light on L.A. artists as the Hammer has done for more than a decade was among the museum's primary motivations for organizing *Made in L.A. 2012*, and it is also the primary goal of the Mohn Award. Encouraging people to see the show is paramount, and by offering this award—which the audience has a stake in granting—the Hammer hopes to engage a broader audience.

"The Mohn Award is a great reflection of Jarl and Pamela's commitment to L.A.'s creative community and is a remarkable gift supporting emerging and overlooked artists in Los Angeles," says Hammer Director Annie Philbin. "Their enthusiasm about the public participation in selecting the award's finalist speaks to their desire to also help cultivate and support a broad and engaged audience for contemporary art in L.A. Obviously this is in line with many of the Hammer's goals and it has been truly a great pleasure to work with them on *Made in L.A.*"

THE MOHN AWARD

All sixty artists in all three venues of *Made in L.A. 2012* are eligible to win the Mohn Award. The professional jury who will select the finalists is comprised of peers from the contemporary art world around the country, including independent curator and writer Anthony Huberman, Doryun Chong Associate curator at the Museum of Modern Art in New York; Cecilia Alemani, the Curator and Director of High Line Art Program; and Rita Gonzalez, curator of contemporary art at LACMA. The significant cash award will be accompanied by a limited edition monographic volume on the winning artist's work. Jarl and Pamela Mohn's commitment to the award extends through the first five cycles of *Made in L.A.* with the option to continue beyond. The

jury and public are both asked to select the artist whose presentation of work stands out as exceptional in *Made in L.A. 2012*.

“I truly believe that L.A. is the creative capital of the world and we are delighted to work with Annie and her team at the Hammer in the establishment of this award,” says Jarl Mohn. “It is our hope that the award brings significant attention to *Made in L.A.* as well as the thriving contemporary art scene in L.A. The most innovative and advanced work in the world is being created right here.”

FIVE FINALISTS AND PUBLIC VOTING FOR THE MOHN AWARD

The five curator-selected finalists will be announced on June 28 at a *Hammer Bash!*—a public event celebrating the exhibition—and voting will commence immediately. Visitors to the exhibition will register to vote onsite at either the Hammer Museum or the Los Angeles Municipal Art Gallery and may only vote once they are registered (photo ID will be required). This process ensures that each voter has actually attended the exhibition and that each person can only cast one vote. The Hammer is working with Trofee, a state certified digital voting platform, used by organizations such as UCLA and The Emmy Awards. This platform has the highest levels of security to ensure that the voting is secure and the results are authenticated. Voting will end on August 12 and the finalist will be announced soon after.

JARL MOHN

Jarl and Pamela Mohn are art collectors committed to supporting emerging L.A. artists. Professionally, Jarl Mohn divides his time between being a corporate director and advisor to a number of media companies, making direct early stage angel and seed investments in digital media/technology ventures, and managing The Mohn Family Foundation—the philanthropic entity he and his wife created in 2000. In addition to supporting arts initiatives, the Mohn Family Foundation funded the Mohn Broadcast Center for KPCC, a significant contribution to Public Radio in Southern California.

Previously he was the founding President and CEO of Liberty Digital, a public company that invested in interactive television, cable networks, and the internet. Prior to Liberty Digital, Jarl created E! Entertainment Television serving as its President and CEO from January 1990 to December 1998. Mohn was formerly Executive Vice President and General Manager of MTV and VH1 from 1986 to 1990 where he led the transformation from music videos to long form programming. Prior to his career in television, Mohn had a 19 year career in radio. He began as a disc jockey and moved through the ranks as a programmer, general manager, and then owner of a group of radio stations.

Originally from Doylestown, Pennsylvania, Mohn attended Philadelphia’s Temple University where he studied mathematics and philosophy. He currently lives in Brentwood with his wife.

Made in L.A. 2012 is organized by the Hammer Museum in collaboration with LA><ART.

The exhibition is presented by



Major support is provided by the Annenberg Foundation; the City of Los Angeles Department of Cultural Affairs; Fundación Jumex, A.C.; Kayne Foundation—Ric & Suzanne Kayne and Jenni, Maggie & Saree; The Mohn Family Foundation; and the members of the Hammer Circle.

The Venice Beach Biennial is made possible by the Teiger Foundation.

Generous support is also provided by the National Endowment for the Arts; the Bloom Family; Gail and Stanley Hollander; Linda and Jerry Janger; Dori Peterman Mostov and Charles Mostov; Karyn Kohl; Heidi and Erik Murkoff; Julie and Barry Smooke; Amy Adelson and Dean Valentine; The Fran and Ray Stark Foundation; and an anonymous donor.

Additional support is provided by the Pasadena Art Alliance; Alumnos 47; ForYourArt; and the LA><ART Producers Council.

KCRW 89.9 FM is the official radio sponsor. *Los Angeles* magazine is the official print sponsor. Special thanks to American Apparel.



ABOUT THE HAMMER MUSEUM

The Hammer Museum, a public arts unit of the University of California, Los Angeles, is dedicated to exploring the diversity of artistic expression through the ages. Its collections, exhibitions, and programs span the classic to the cutting-edge in art, architecture, and design, recognizing that artists play a crucial role in all aspects of culture and society.

The museum houses the Armand Hammer Collection of Old Master, Impressionist, and Post-Impressionist paintings and the Armand Hammer Daumier and Contemporaries Collection. The museum also houses the Grunwald Center for the Graphic Arts, comprising more than 45,000 prints, drawings, photographs, and artists' books from the Renaissance to the present; and oversees the management of the Franklin D. Murphy Sculpture Garden on the UCLA campus. The Hammer's newest collection, the Hammer Contemporary Collection, is highlighted by works by artists such as Lari Pittman, Kara Walker, Ed Ruscha, Barbara Kruger, Mark Bradford, Richard Hawkins, Lynn Foulkes, among many others.

The Hammer presents major single-artist and thematic exhibitions of historical and contemporary art. It also presents approximately ten Hammer Projects exhibitions each year, providing international and local artists with a laboratory-like environment to create new work or to present existing work in a new context.

As a cultural center, the Hammer offers a diverse range of free public programs throughout the year, including lectures, readings, symposia, film screenings, and music performances. The Hammer's Billy Wilder Theater houses these widely acclaimed public programs and is the new home of the UCLA Film & Television Archive's renowned cinematheque.

HAMMER MUSEUM INFORMATION

For current program and exhibition information call **310-443-7000** or visit **www.hammer.ucla.edu**.

Hours: Tuesday–Friday 11am–8pm; Saturday & Sunday 11am – 5 pm; closed Mondays, July 4, Thanksgiving, Christmas, and New Year’s Day.

Admission: \$10 for adults; \$5 for seniors (65+) and UCLA Alumni Association members; free for Museum members, students with identification, UCLA faculty/staff, military personnel, veterans, and visitors 17 and under. The Museum is free on Thursdays for all visitors. Public programs are always free.

Location/Parking: The Hammer is located at 10899 Wilshire Boulevard, at Westwood Boulevard. Parking is available under the Museum. Rate is \$3 for three hours with Museum validation. Bicycles park free.

Hammer Museum Tours: For group tour reservations and information, call 310-443-7041.

Made in L.A. 2012 Artist List (Alphabetical)

Scoli Acosta
Kathryn Andrews
Animal Charm (Richard Bott & Jim Fetterley)
Math Bass
Scott Benzel
Sarah Cain
Sarah Conaway
Fiona Connor
Kate Costello
Meg Cranston
Nzuji de Magalhães
Michelle Dizon
Roy Dowell
Zackary Drucker (In collaboration with Rhys Ernst)
Patricia Fernández
Cayetano Ferrer
Dan Finsel
Morgan Fisher
Simone Forti
Liz Glynn
Mark Hagen
Zach Harris
Kenyatta A. C. Hinkle
Channa Horwitz
Pearl C. Hsiung
Ashley Hunt
Vishal Jugdeo
Mimi Lauter
Thomas Lawson
Nery Gabriel Lemus
Dashiell Manley
Allison Miller
Nicole Miller
Meleko Mokgosi
Zac Monday
Ruby Neri
D'Ette Nogle
Alex Olson
Michele O'Marah
Camilo Ontiveros
Joel Otterson
Karthik Pandian
The Propeller Group (Phunam Thuc Ha, Matt Lucero & Tuan Andrew Nguyen)
Vincent Ramos
Laura Riboli
Ry Rocklen
Miljohn Ruperto
Analia Saban
Brian Sharp
Slanguage (Mario Ybarra Jr. & Karla Diaz)
Ryan Sluggett
David Snyder
Jill Spector
Koki Tanaka
Henry Taylor
Caroline Thomas
Cody Trepte
Erika Vogt
Lisa Williamson
Brenna Youngblood

MADE IN L.A. 2012 Artist Biographies

Scoli Acosta

Born 1973 in Los Angeles

Lives and works in Koreatown

Kathryn Andrews

Born 1973 in Mobile, AL

Lives in Eagle Rock and works in Highland Park

Animal Charm

Richard Bott born 1972 in Louisville, KY

Jim Fetterley born 1971 in Rockford, IL

Both live and work in Highland Park

Math Bass

Born in New York, NY

Lives and works in Historic Filipinotown

Scott Benzel

Born 1968 in Scottsdale, AZ

Lives and works in Elysian Heights

Sarah Cain

Born 1979 in Albany, NY

Lives and works in Los Angeles

Sarah Conaway

Born 1972 in York, Pennsylvania

Lives and works in Koreatown

Fiona Connor

Born 1981 in Auckland, New Zealand

Lives and works in Historic Filipinotown

Kate Costello

Born 1974 in Newfane, VT

Lives and works in Los Angeles

Meg Cranston

Born 1960 in Baldwin, NY

Lives in Los Angeles and works in Santa Monica

Nzuj de Magalhães
Born 1976 in Luanda, Angola
Lives in Costa Mesa

Michelle Dizon
Born 1977 in Los Angeles, CA
Lives and works in Lincoln Heights

Roy Dowell
Born 1951 in Bronxville, NY
Lives and works in La Crescenta

Zackary Drucker (In collaboration with Rhys Ernst)
Born 1984 in Dewitt, NY
Lives and works in Silver Lake

Patricia Fernández
Born 1980 in Burgos, Spain
Lives in Chinatown and works in Echo Park

Cayetano Ferrer
Born 1981 in Honolulu, HI
Lives and works in Koreatown

Dan Finsel
Born 1982 in Lehigh, PA
Lives in Chinatown and works in Chatsworth and Chinatown

Morgan Fisher
Born 1942 in Washington, DC
Lives and works in Santa Monica

Simone Forti
Born 1935 in Florence, Italy
Lives and works in Westwood

Liz Glynn
Born 1981 in Boston, MA
Lives and works in Chinatown

Mark Hagen
Born 1972 in Black Swamp, VA
Lives and works in Eagle Rock

Zach Harris
Born 1976 in Santa Rosa, CA
Lives and works in Echo Park

Kenyatta A. C. Hinkle
Born 1987 in Louisville, KY
Lives and works in Valencia

Channa Horwitz
Born 1932 in Los Angeles, CA
Lives and works in West Los Angeles

Pearl C. Hsiung
Born 1973 in Taichung, Taiwan
Lives in Mount Washington and works in Glassell Park

Ashley Hunt
Born 1970 in Los Angeles, CA
Lives and works in Van Nuys

Vishal Jugdeo
Born 1979 in Regina, Canada
Lives in Silver Lake and works in Highland Park

Mimi Lauter
Born 1982 in San Francisco, CA
Lives and works Downtown

Thomas Lawson
Born 1951 in Glasgow, Scotland
Lives in Los Angeles and works in Echo Park

Nery Gabriel Lemus
Born 1977 in Los Angeles
Lives and works in Arcadia

Dashiell Manley
Born 1983 in Fontana, CA
Lives in Echo Park and works in Lincoln Heights

Allison Miller
Born 1974 in Evanston, IL
Lives and works in Echo Park

Nicole Miller
Born 1982 in Tuscon, AZ
Lives and works in Koreatown

Meleko Mokgosi
Born 1981 in Gaborone, Botswana
Lives and works in Culver City

Zac Monday
Born 1985 in Meadville, PA
Lives in Silver Lake and works in Cypress Park

Ruby Neri
Born 1970 in San Francisco
Lives and works in Highland Park

D'Ette Nogle
Born 1974 in Los Angeles, CA
Lives and works in Hermon

Alex Olson
Born 1978 in Boston, MA
Lives in Silver Lake and works in Lincoln Heights

Michele O'Marah
Born 1967 in Vallejo, CA
Lives in Rampart Village and works in Boyle Heights

Camilo Ontiveros
Born 1978 in Rosario, Sinaloa, Mexico
Lives in Lincoln Heights and works in South LA

Joel Otterson
Born in 1959, Inglewood, CA
Lives in Hollywood and works in Lincoln Heights

Karthik Pandian
Born 1981 in Los Angeles, CA
Lives in Thai Town and works in Lincoln Heights

The Propeller Group

Phunam Thuc Ha, born 1974 in Saigon, South Vietnam

Matt Lucero, born 1976 in Upland, CA

Tuan Andrew Nguyen, born 1976 in Saigon, South Vietnam

All live and work in Los Angeles and Ho Chi Minh City, Vietnam

Vincent Ramos

Born 1973 in Santa Monica, CA

Lives and works in Venice

Laura Riboli

Born 1973 in Los Angeles, CA

Lives in Los Feliz and works in Glassell Park

Ry Rocklen

Born 1978 in Los Angeles, CA

Lives in Los Feliz and works in Lincoln Heights

Miljohn Ruperto

Born 1971 in Manila, Philippines

Lives in Koreatown and works Downtown

Analia Saban

Born 1980 in Buenos Aires, Argentina

Lives and works in Santa Monica

Brian Sharp

Born 1974 in Akron, OH

Lives and works in Mid-City

Slanguage

Mario Ybarra Jr. born 1973 in Los Angeles, CA

Karla Diaz born 1976 in Los Angeles, CA

Both live and work in Wilmington

Ryan Sluggett

Born 1981 in Calgary, Alberta, Canada

Lives in Village Green and works in West Adams

David Snyder

Born 1979 in Rochester, NY

Lives in Santa Monica and works in Lincoln Heights

Jill Spector
Born 1976 in York, PA
Lives and works in Altadena

Koki Tanaka
Born 1975 in Tochigi, Japan
Lives and works Downtown

Henry Taylor
Born 1958 in Oxnard, CA
Lives in Little Tokyo and works in Chinatown

Caroline Thomas
Born 1972 in San Francisco, CA
Lives in Silver Lake and works in Boyle Heights

Cody Trepte
Born 1983 in Austin, TX
Lives in Los Feliz and works Downtown

Erika Vogt
Born 1973 in East Newark, New Jersey
Lives and works in Highland Park

Lisa Williamson
Born 1977 in Urbana, IL
Lives in Echo Park and works in Lincoln Heights

Brenna Youngblood
Born 1979 in Riverside, CA
Lives and works Downtown

MADE IN L.A.

2012

dca DEPARTMENT OF CULTURAL AFFAIRS
City of Los Angeles

HAMMER

LA \times ART

PRESENTED BY

WELLS
FARGO

PARTICIPATING ARTISTS

SCOLI ACOSTA

KATHRYN ANDREWS

ANIMAL CHARM

MATH BASS

SCOTT BENZEL

SARAH CAIN

SARAH CONAWAY

FIONA CONNOR

KATE COSTELLO

MEG CRANSTON

NZUJI DE MAGALHÃES

MICHELLE DIZON

ROY DOWELL

ZACKARY DRUCKER & RHYS ERNST

PATRICIA FERNÁNDEZ

CAYETANO FERRER

DAN FINSEL

MORGAN FISHER

SIMONE FORTI

LIZ GLYNN

MARK HAGEN

ZACH HARRIS

KENYATTA A. C. HINKLE

CHANNA HORWITZ

PEARL C. HSIUNG

ASHLEY HUNT

VISHAL JUGDEO

MIMI LAUTER

THOMAS LAWSON

NERY GABRIEL LEMUS

DASHIELL MANLEY

ALLISON MILLER

NICOLE MILLER

MELEKO MOKGOSI

ZAC MONDAY

RUBY NERI

D'ETTE NOGLE

ALEX OLSON

MICHELE O'MARAH

CAMILO ONTIVEROS

JOEL OTTERSON

KARTHIK PANDIAN

THE PROPELLER GROUP

VINCENT RAMOS

LAURA RIBOLI

RY ROCKLEN

MILJOHN RUPERTO

ANALIA SABAN

BRIAN SHARP

SLANGUAGE

RYAN SLUGGETT

DAVID SNYDER

JILL SPECTOR

KOKI TANAKA

HENRY TAYLOR

CAROLINE THOMAS

CODY TREPTE

ERIKA VOGT

LISA WILLIAMSON

BRENNA YOUNGBLOOD

MADE IN L.A.

2012

JUNE 2 – SEPTEMBER 2, 2012

Made in L.A. 2012 is the Hammer Museum's first large-scale biennial survey of the work of Los Angeles-based artists. Organized by the Hammer in collaboration with LA><ART—institutions with a long-standing commitment to recognizing and supporting Los Angeles' extraordinary community of artists—the exhibition further underscores our dedication to the local art scene and our shared belief that one of our city's greatest assets is its artists.

Los Angeles is home to some of the most original and innovative artists working today. Spread out across varied neighborhoods, the region can be seen as a microcosm of the nation—and even of the world—with all its diversity, complexity, and vibrancy. In recent years, increased attention to the city's artistic production has led to a greater awareness of its position as a site for experimentation and has allowed artists to reach audiences far outside the city. Conversely, Los Angeles artists are bringing their unique perspectives about global issues to local audiences. This exhibition not only examines what is happening here “on the ground” but also brings into focus how our city engages with international contemporary art discourses.

Made in L.A. 2012 presents the work of artists in the early stages of their careers alongside that of midcareer artists who are vital to our community yet are arguably underrecognized. The vast majority of works on view were created specifically for the exhibition and reveal the extraordinary array of practices found in our sprawling and multifaceted city. The exhibition features figurative and abstract painting, sculpture, video installation, site- and situation-specific works, photography, works on paper, and a series of performances and public programs.

This exhibition includes work by 60 artists, shown at three locations across the city: the Hammer Museum in Westwood, LA><ART in the Culver City art district, and the Los Angeles Municipal Art Gallery at Barnsdall Park in Los Feliz.

—Anne Ellegood, Lauri Firstenberg, Malik Gaines, Cesar Garcia, Ali Subotnick: *Made in L.A. 2012* curatorial team.

PERFORMANCES AND PUBLIC PROGRAMS

PUBLIC OPENINGS

SAT | JUNE 2 | 11AM–5PM | HAMMER MUSEUM

SAT | JUNE 2 | 12–3PM | LA><ART

SUN | JUNE 3 | 2–5PM | LA MUNICIPAL ART GALLERY

HAMMER BASH!

THU | JUNE 28 | 7PM | HAMMER MUSEUM

Come celebrate the kickoff of the *Made in L.A. 2012* music series with a live set by KCRW DJ **Jason Bentley**, free museum admission, and a cash bar. The night will feature a special performance by *Made in L.A.* artist **Scott Benzel**.

D'ETTE NOGLE

MEDITATION BELL FOR MUSEUM

EVERY DAY DURING MUSEUM HOURS | HAMMER MUSEUM

D'Ette Nogle conceived of this project in response to the Hammer's weekly mindfulness sessions led by UCLA's Mindful Awareness Research Center (MARC), which was "created to bring to a renowned mental health research institution the ancient art of mindful awareness in a scientifically supported and rigorous form." At the conclusion of each session, the facilitator chimes a bell. For Nogle's intervention, a bell will chime at 20-minute intervals throughout the museum in an effort to allow the institution's affiliation with mindfulness to literally permeate its spaces.

ZAC MONDAY

**RED: AS SLAPSTICK; WHITE: PASS IT ON;
BLUES & GREENS: FOLLOWS, FEELS, AND FAILS;
BROWN: BOWS DOWN, HANDS IT OVER, LOOKS AWAY
BLACK: CAKE IS GREAT EVEN IN WEIGHT**

JUNE 3 | LA MUNICIPAL ART GALLERY

JUNE 7, 22 | JULY 5, 19 | AUG 2, 16, 30 | HAMMER MUSEUM

Zac Monday will use his cast of characters donning vibrant, ornate, fantastical hand-crocheted costumes to present different scenarios around the gallery spaces. Enacted by performers, these figures call attention to architectural moments, emotional

expectations, and the psychogeographic space of the museum. They animate the building with mysterious, playful, and haunting physical forms that dawdle, crawl, and linger. **Performances take place without set times**, bringing an element of spontaneity and the unexpected to museumgoers' experiences.

SIMONE FORTI

NEWS ANIMATIONS

TUE | JUNE 12 | 7PM | LA><ART

THU | JULY 19 | 7PM | BARNSDALL GALLERY THEATRE

THU | JULY 26 | 7PM | HAMMER MUSEUM

THU | AUG 16 | 7PM | HAMMER MUSEUM

THU | AUG 30 | 7PM | BARNSDALL GALLERY THEATRE

Developed in the mid-1980s, **Simone Forti's** *News Animations* encompasses the translation of the imagery and language of newspaper reports and newscasts into improvised movement compositions. Listening to and reading the news in the months leading up to *Made in L.A. 2012*, Forti has produced a series of writings and drawings that she will translate into collaborative improvisational performances done throughout the duration of the exhibition at all three venues.

KENYATTA A. C. HINKLE

KENTIFRICA IS: AN ETHNOMUSICOLOGY PERFORMANCE

THU | JUNE 14 | 7:30PM | HAMMER MUSEUM

THU | AUG 2 | 7:30PM | BARNSDALL GALLERY THEATRE

Drawing from her long-term autoethnographical project *Kentifrica*, which encompasses the creation of a revival of a continent where the histories of Kentucky and the ancestral heritage of West Africa converge, **Kenyatta A. C. Hinkle** will present two concerts by ethnomusicologists studying Kentifrican musical forms. Working in collaboration with performer/composer Kevin Robinson and instrument maker and musician Eugene Moon, Hinkle has created a series of instruments and original musical compositions inspired by different regions of *Kentifrica*.

ASHLEY HUNT

NOTES ON THE EMPTYING OF A CITY

THU | JUNE 21 | 7:30PM | BARNSDALL GALLERY THEATRE
TUE | JULY 10 | 7:30PM | HAMMER MUSEUM

Notes on the Emptying of a City revolves around Hurricane Katrina and the questions of race, visibility, and speech that the catastrophe continues to reveal. Alone on stage, **Ashley Hunt** narrates his experiences of working with a delegation of social justice activists in New Orleans while presenting images of the city interspersed with video of citizens' testimony. What looks at first like a traditional slide lecture quickly turns into storytelling, completed at the end by a discussion with the audience.

SCOTT BENZEL

(THRENOLOGY) A BEGINNER'S GUIDE TO MAO TSE-TUNG— FOR 2 TAPE LOOPS, DANCERS, CELLO, VIOLA, VIOLIN, AND PERCUSSION

FRI | JUNE 22 | 7:30PM | HAMMER MUSEUM
THU | JUNE 28 | 7:30PM | HAMMER MUSEUM

This performance features two reel-to-reel tape machines in the center of the performance space. The tape loops are stretched between dancers costumed as the faux Maoist rebel portrayed by Sharon Tate in a 1967 issue of *Esquire*. The photo-essay that inspired this performance was accompanied by aphorisms from Chairman Mao's Little Red Book and featured a scantily clad Tate surrounded by luxury goods. In **Scott Benzel's** translation, each dancer employs a different appliance to maintain tape tension. The looping tapes play an electronic composition while a cellist, violist, violinist, and percussionist play both a predetermined score and improvised reactions to the loops.

CONTINUED ON PAGE 8

VENICE BEACH BIENNIAL

FRI–SUN | JULY 13–15 | VENICE BEACH BOARDWALK

The *Venice Beach Biennial* (VBB), a weekend event that makes tongue-in-cheek reference to the “real” Venice Biennale in Italy, treats the famed Venice Beach boardwalk, Ocean Front Walk, as an outdoor exhibition venue. Over the course of the weekend, some 30 to 40 artists will set up vending stands alongside the veteran boardwalk artists, exhibiting new bodies of work, collaborating with the veterans on new projects, displaying site-specific sculptures or installations, and presenting live performances. The *Venice Beach Biennial* is presented in conjunction with *Made in L.A. 2012* and directed by Hammer curator Ali Subotnick.

The *Venice Beach Biennial* is made possible by the Teiger Foundation.

VISIT THE WEBSITE FOR MORE INFORMATION:
WWW.MADEINLA2012.ORG



Arture “Art” Moore. *Funky Pussy*, (detail). beerforart.blogspot.com

HAMMER MUSEUM

10899 WILSHIRE BLVD
LOS ANGELES, 90024

ADMISSION: \$10. Free Every Thursday.

HOURS: Tues–Fri 11am–8pm; Sat & Sun 11am–5pm; Closed Monday

GALLERY LEVEL

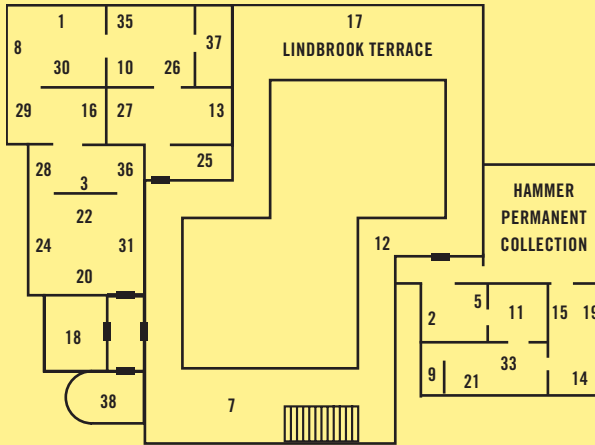

COURTYARD LEVEL

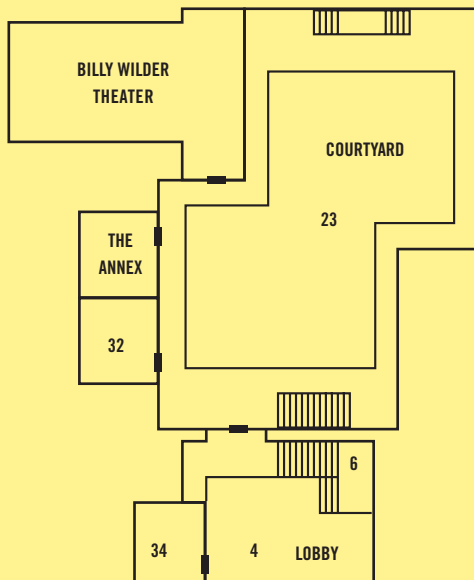

- 1 SCOLI ACOSTA
- 2 KATHRYN ANDREWS
- 3 SARAH CONAWAY
- 4 FIONA CONNOR
- 5 KATE COSTELLO
- 6 MEG CRANSTON
- 7 NZUJI DE MAGALHÃES
- 8 ROY DOWELL
- 9 ZACKARY DRUCKER & RHYS ERNST
- 10 PATRICIA FERNÁNDEZ
- 11 DAN FINSEL
- 12 MORGAN FISHER
- 13 LIZ GLYNN
- 14 MARK HAGEN
- 15 ZACH HARRIS
- 16 CHANNA HORWITZ
- 17 PEARL C. HSIUNG
- 18 VISHAL JUGDEO
- 19 MIMI LAUTER
- 20 THOMAS LAWSON
- 21 MELEKO MOKGOSI
- 22 RUBY NERI
- 23 D'ETTE NOGLE
- 24 ALEX OLSON
- 25 CAMILO ONTIVEROS
- 26 JOEL OTTERSON
- 27 KARTHIK PANDIAN
- 28 LAURA RIBOLI
- 29 ANALIA SABAN
- 30 BRIAN SHARP
- 31 RYAN SLUGGETT
- 32 DAVID SNYDER
- 33 JILL SPECTOR
- 34 KOKI TANAKA
- 35 CAROLINE THOMAS
- 36 CODY TREPTE
- 37 ERIKA VOGT
- 38 LISA WILLIAMSON

LA MUNICIPAL ART GALLERY

AT BARNSDALL PARK

4800 HOLLYWOOD BLVD
LOS ANGELES, 90027

ADMISSION: Free

HOURS: Tues–Fri 11am–8pm; Sat & Sun 11am–5pm; Closed Monday

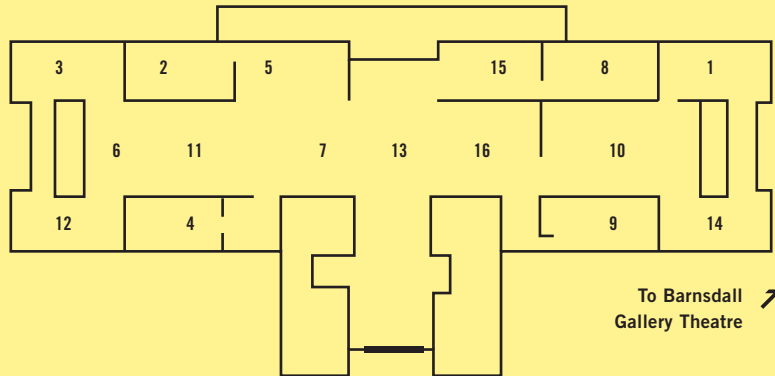

- 1 ANIMAL CHARM
- 2 SARAH CAIN
- 3 MICHELLE DIZON
- 4 CAYETANO FERRER
- 5 SIMONE FORTI
- 6 NERY GABRIEL LEMUS
- 7 DASHIELL MANLEY
- 8 ALLISON MILLER
- 9 NICOLE MILLER
- 10 MICHELE O'MARAH
- 11 THE PROPELLER GROUP
- 12 VINCENT RAMOS
- 13 RY ROCKLEN
- 14 MILJOHN RUPERTO
- 15 HENRY TAYLOR
- 16 BRENNA YOUNGBLOOD

LA <ART

2640 SOUTH LA CIENEGA BLVD
LOS ANGELES, 90034

ADMISSION: Free

HOURS: Tues–Sat 11am–6pm; Closed Sunday & Monday

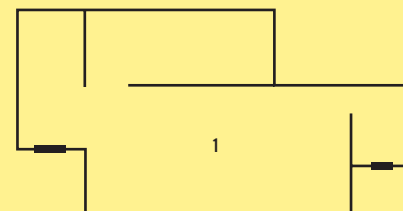

- 1 SLANGUAGE

BILLBOARDS

LA CIENEGA BLVD. (BETWEEN VENICE & WASHINGTON BLVD.)

JUNE	SLANGUAGE
JULY	ROY DOWELL
AUG	MEG CRANSTON

HOLLYWOOD BLVD. (AT THE ENTRANCE OF BARNSDALL PARK)

JULY/AUG	NICOLE MILLER
AUG/SEPT	CAYETANO FERRER

SUNSET BLVD. (AT OLIVE DRIVE IN WEST HOLLYWOOD)

THE PROPELLER GROUP

VISIT THE WEBSITE FOR ADDITIONAL INFORMATION & DIRECTIONS TO ALL VENUES: WWW.MADEINLA2012.ORG

PERFORMANCES AND PUBLIC PROGRAMS

MATH BASS

BRUTAL SET

FRI | JUNE 22 | 8PM | HAMMER MUSEUM

SUN | JUNE 24 | 3PM | HAMMER MUSEUM

Math Bass brings a chorus of collaborators together for a performance that meditates on bodies absorbed in stillness. A sculptural set made of staircases and cinder blocks creates a stage on which performers act out different phases of physical and emotional transformation. Language serves as both image and object as voices interact with set pieces in this spiraling narrative. This new work is the latest of Bass's innovative performances that playfully negotiate bodies in space.

FIONA CONNOR

LOBBIES ON WILSHIRE

JUNE 28–JULY 12 | MUSEUM HOURS | HAMMER MUSEUM

As part of her installation *Lobbies on Wilshire*, artist **Fiona Connor** will initiate a two-week publishing workshop within the architecture of her installation. Connor will work with invited guests and museum visitors to produce an alternative publication to the Hammer Museum's official catalogue for *Made in L.A. 2012*. Connor's publication, produced on-site using a commercial photocopier, will document the various reactions to the exhibition from within the space.

MICHELLE DIZON

PERPETUAL PEACE

FRI | JUNE 29 | 8:30PM | BARNSDALL GALLERY THEATRE

Perpetual Peace is a live performance that accompanies a feature-length video about contemporary globalization in the Philippines. The artist's narration and a live music score contextualize a lush and challenging set of images shot by **Michelle Dizon** in the Philippines. The work explores the nexus between the legacy of colonialism, the extraction of resources from the third world, the biopolitics of migrant labor, the U.S. remilitarization of its former colonies, the postcolonial diaspora, and the human cost of empire.

ARTIST CONVERSATIONS

THU | JULY 12 | 7:30PM | BARNSDALL GALLERY THEATRE

Participating artists will frame and contextualize their work through talks, discussions, screenings, and performances. Artists include **Meg Cranston, Vishal Jugdeo, Dashiell Manley, Nicole Miller, and Ry Rocklen**. Artist list subject to change.

KOKI TANAKA

INTIMATE ORCHESTRA

SUN | AUG 5 | 2PM & 2:30PM | HAMMER MUSEUM

Koki Tanaka will elaborate on his video installation by activating the Lobby Gallery with an intimate performance. Tanaka will invite 10 flutists to perform simultaneously for 10 audience members, each flutist playing directly to one audience member who is situated nearby. Like Tanaka's video, which focuses on two marimba players negotiating the same instrument, this piece transforms the usual artistic arrangement and invites unexpected outcomes in a live musical experiment.

NZUJI DE MAGALHÃES

DAILY PERPLEXITIES

SUN | AUG 5 | 3:30PM | HAMMER MUSEUM

SUN | AUG 12 | 3:30PM | HAMMER MUSEUM

In *Daily Perplexities*, four hand-painted pianos are played simultaneously by several pianists, who perform a score inspired by the lives of children. **Nzuji De Magalhães** covered her pianos with images of a scene that could exist in L.A., Africa, or somewhere in between. The delightful manner in which these pianos are played—players stand behind them and play them “upside down”—reflects the artist's innovative ways of approaching her work.

VINCENT RAMOS

HERE THE POETS CHOP THEIR FINGERS SERVED UNDER GLASS

SAT | AUG 18 | 4PM | LA MUNICIPAL ART GALLERY

Vincent Ramos's installation features several unannounced performative actions representing cultural archetypes/ stereotypes from the postwar period that have emerged from the artist's extensive research of Venice Beach in the 1950s. On August 18 actress **Christie Herring** will give an in-character lecture as local late night horror host Vampira.

THE ARTIST THEATER PROGRAM: A GROUP SHOW OF FILM AND VIDEO BY VISUAL ARTISTS

TUE | AUG 21 | 7:30PM | HAMMER MUSEUM

Organized by **Erika Vogt** as a community-building effort using the screen as a site for experience, the screening is a chorus of parts: moving parts, speaking parts, skeletal parts, muscle parts, parts for the eyes, parts for the senses, parts for thought, and parts for the imagination. Artists include **Jean-Marie Straub and Danièle Huillet, Alice Könitz, Paul Sietsema, Adam Putnam, James Welling, Madison Brookshire and Tashi Wada, Math Bass, Shannon Ebner, Lucy Raven, W.A.G.E Coalition,** and musicians **Mark So** and **Tashi Wada.**

ZACKARY DRUCKER

ZACKARY DRUCKER & HER FRIENDS: FILMS & CONVERSATION

WED | AUG 22 | 7:30PM | HAMMER MUSEUM

Zackary Drucker hosts an evening of film screenings and conversation examining the poetics and politics of conflated gender, performative documentation, and queer cinema. Films: *The Queen*, starring Mother Flawless Sabrina (1968, dir. Frank Simon, 68 min.); *Broken Goddess*, starring Holly Woodlawn (1973, dir. Dallas, 20 min.); and *At least you know: you exist* (2011, dir. Zackary Drucker with Flawless Sabrina, 16 min.). Followed by a conversation with Drucker, Flawless Sabrina, and Woodlawn. Cash bar at 7:30PM, screening at 8:30PM.

MADE IN L.A. MUSIC

EVERY THURSDAY FROM JUNE 28 – AUGUST 9

Celebrating *Made in L.A. 2012*, the Hammer and **KCRW 89.9 FM** present *Made in L.A. Music* Thursday evenings this summer. KCRW DJs take up residence in the Hammer's outdoor courtyard, selecting sets inspired by the idea of *Made in L.A.* and representing the wide array of music created in this city.

KCRW music director and host of *Morning Becomes Eclectic* **Jason Bentley** will launch the series at the Hammer Bash! on Thursday, June 28 (see page 4 for details). Galleries open late each week. Featuring special guests, cash bar, prizes and free museum admission.

HAMMER BASH! THURSDAY, JUNE 28, 7–11PM

JASON BENTLEY

THURSDAY, JULY 5, 7–10PM

CHUCK P

THURSDAY, JULY 12, 7–10PM

ANNE LITT

THURSDAY, JULY 19, 7–10PM

CHRIS DOURIDAS

THURSDAY, JULY 26, 7–10PM

ANTHONY VALADEZ

THURSDAY, AUGUST 2, 7–10PM

JEREMY SOLE

THURSDAY, AUGUST 9, 7–11PM

VALIDA

VISIT THE WEBSITE FOR DJ SET TIMES:
WWW.MADEINLA2012.ORG

SLANGUAGE AT LA><ART

THIS IS A TAKEOVER! A 10-YEAR SURVEY OF SLANGUAGE

Internationally renowned artists' collective **Slanguage** will activate LA><ART throughout the duration of the exhibition. Alongside a public billboard project, a new mural on LA><ART's facade, and an interactive installation documenting 10 years of the collective's projects, Slanguage will host public programs, events, and performances that will give audiences access to its pedagogical process of artistic creation. **Please note that some programs require an RSVP.**

SLANGUAGE JR. ART WORKSHOPS

SAT | JUNE 16 | 12–2PM | RSVP BY JUNE 9

SAT | JULY 21 | 12–2PM | RSVP BY JULY 14

SAT | AUG 4 | 12–2PM | RSVP BY JULY 28

Led by different contemporary artists from Los Angeles, these three workshops will provide a dynamic opportunity for children and youth ages 5 to 13 to make their own works of art in a wide variety of media. From collages and painting to sculpture and installation, these workshops bring young audiences and artists together for a family friendly arts education experience. **RSVP required.**

ARTISTS ANONYMOUS GROUP MEETINGS

WED | JUNE 27 | 7–8:30PM | RSVP BY JUNE 20

WED | JULY 25 | 7–8:30PM | RSVP BY JULY 18

WED | AUG 15 | 7–8:30PM | RSVP BY AUG 8

Organized and moderated by Slanguage, these discussion forums for artists will be structured around distinct themes, creating a space for creative practitioners to discuss some of the most pressing personal and professional issues facing contemporary artists today. These discussion forums will serve as safe spaces for candid conversations and are open to artists only. **RSVP required.**

WORLD'S WORST WORDS: AN EVENING OF SPOKEN WORD, MUSIC, AND PERFORMANCE

FRI | JULY 20 | 7–10PM

Join Slanguage for an evening of experimental music, spoken word, poetry, readings, and performances. Various short works and performances curated by Slanguage will be presented throughout the night.

SLANGUAGE TEEN ART COUNCIL'S TEEN ARTS SUMMIT

SAT | AUG 11 | 11AM–5PM

Slanguage's Teen Arts Council organizes a citywide summit for teen arts leaders involved in myriad arts education programs throughout Los Angeles County. During this symposium-like event, teens will share programmatic ideas, discuss the challenges of organizing youth arts programs, share experiences, and form networks for possible future collaborations.

SLANGFEST 2

SAT | AUG 25 | 11AM–6PM

12PM | BASS ELEGY/DEVIL'S NIGHT (FOR M.K.)

The second annual *Slangfest* is a daylong festival of art workshops, music, and performances. Art activity booths will host family workshops while a lineup of performances including break-dancing and live bands takes the stage. Food trucks will be present during the event. At noon, **Scott Benzel** and **Mark Hagen** will fit a wrecked car with a custom pyramidal bass cabinet and play a mix of GhettoTech, Booty bass, and early Detroit Techno as well as a live original composition through it. Incorporating both a dense mix of sound to create extreme vibrations and slow compositions using live musicians, *Bass Elegy/Devil's Night (for M.K.)* is an elegy to one of our city's most influential and pioneering artists, Mike Kelley.

RSVP FOR EVENTS:
SLANGUAGERSVP@LAXART.ORG / 310-559-0166

VISIT THE WEBSITE FOR MORE INFORMATION:
MADEINLA2012.ORG

MOHN PRIZE

THE MOHN PRIZE

Established with the inauguration of the *Made in L.A.* biennial series, the Mohn Prize is funded through the generosity of Los Angeles philanthropists and art collectors **Jarl and Pamela Mohn**. The \$100,000 prize will be awarded to one artist featured in *Made in L.A. 2012* and will be accompanied by a publication on the recipient's work. A professional jury will select five finalists for the Mohn Prize. The Prize winner will be chosen by visitors to the exhibition through online and on-site voting.

PUBLIC VOTING BEGINS JUNE 28

The five finalists will be announced on June 28 at a Hammer Bash!—a public event celebrating the exhibition—and voting will commence immediately. All visitors who wish to vote must register onsite at either the Hammer Museum or the Los Angeles Municipal Art Gallery (a photo ID will be required). Votes may be cast onsite or online at **MADEINLA2012.ORG**.

VOTE
★ FOR ★
ART

WWW.MADEINLA2012.ORG

Made in L.A. 2012 is organized by the Hammer Museum in collaboration with LA><ART.

The exhibition is presented by



Major support is provided by the Annenberg Foundation; the Department of Cultural Affairs, City of Los Angeles; Fundación Jumex, A.C.; Kayne Foundation—Ric & Suzanne Kayne and Jenni, Maggie & Saree; The Mohn Family Foundation; and the members of the Hammer Circle.

The Venice Beach Biennial is made possible by the Teiger Foundation.

Generous support is also provided by the National Endowment for the Arts; the Bloom Family; Gail and Stanley Hollander; Linda and Jerry Janger; Dori Peterman Mostov and Charles Mostov; Karyn Kohl; Heidi and Erik Murkoff; Julie and Barry Smooke; Amy Adelson and Dean Valentine; The Fran and Ray Stark Foundation; and an anonymous donor.

Additional support is provided by the Pasadena Art Alliance; Alumnos 47; ForYourArt; and the LA><ART Producers Council.

KCRW 89.9 FM is the official radio sponsor. *Los Angeles* magazine is the official print sponsor.



HAMMER 2012 MADE IN L.A.

LA > < ART

JUNE 2 - SEPTEMBER 2, 2012
SELECTED IMAGES



1. Henry Taylor. *Jesse Owens in '36*, 2010. Acrylic on canvas. 87 1/2 x 77 in. (222.3 x 195.6 cm). Courtesy the artist and Untitled, New York.



2. Roy Dowell. *Untitled #941*, 2008. Paper, cardboard, acrylic and oil paint, wood base. 14 x 14 x 14 in. (35.6 x 35.6 x 35.6 cm). Courtesy the artist. Photo by Brian Forrest.



3. Dan Finsel. *At work in the studio in Chatsworth, CA, 2011. The Space Between You and Me, 2012 (detail)*. Courtesy the artist. Photo by Joshua White.

HAMMER 2012 MADE IN L.A.

LA > < ART

JUNE 2 - SEPTEMBER 2, 2012
SELECTED IMAGES



4. Meg Cranston. *California*, 2006. Gouache and collage on paper. 14 x 11 in. (35.6 x 27.9 cm). Courtesy the artist and Venetia Kapernekas Gallery, New York. Photo by Jeff Sturges.

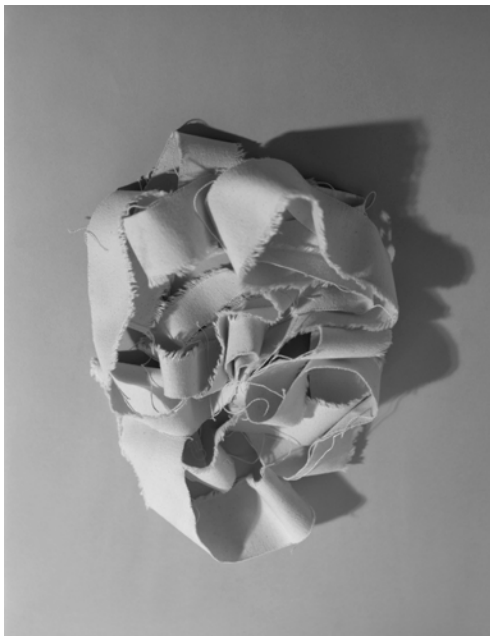

5. Sarah Conaway. *V*, 2011. Chromogenic print. 17 x 22 in. (43.2 x 55.9 cm). Courtesy the artist and The Box, Los Angeles.



6. Lisa Williamson. *Pale Stilts*, 2011. Aluminum, canvas, paper, enamel, acrylic. 56 x 43 x 18 in. (142.2 x 109.2 x 45.7 cm). Installation view, *Weird Walks into a Room (Comma)*, The Box, Los Angeles. Courtesy the artist and Shane Campbell Gallery, Chicago.

HAMMER 2012 MADE IN L.A.

LA > < ART

JUNE 2 - SEPTEMBER 2, 2012
SELECTED IMAGES



7. Nicole Miller. Still from *Untitled*, 2012. Two rooms, three digital projections, color, sound. Runtime not yet determined. Courtesy the artist.



8. Alex Olson. *Archivist*, 2011. Oil on linen. 51 x 36 in. Courtesy the artist; Lisa Cooley, New York; Shane Campbell Gallery, Chicago, and Laura Bartlett Gallery, London. Photo by Lee Thompson.



9. Liz Glynn. *Trojan Surrogates, Large Diadem with Pendants*, 2010 (detail). Paper trash with gold acrylic. 13 1/2 x 18 x 1/8 in. (34.3 x 45.7 x 0.3 cm). Collection of Stacy and John Rubeli. Courtesy the artist and Redling Fine Art, Los Angeles. Photo by Brica Wilcox.

HAMMER 2012 MADE IN L.A.

LA > < ART

JUNE 2 - SEPTEMBER 2, 2012
SELECTED IMAGES



10. Nzuji de Magalhães. *Daily Perplexities*, 2009-12. Performance with four pianos. Dimensions variable. Courtesy the artist. Photo by Robert Wedemeyer.



11. Zac Monday. *Hark and Waite*, 2011. Yarn, synthetic fabric, 72 in. (182.9 cm)-tall human figure. Courtesy the artist. Photo by Noah Doely.

HAMMER 2012 MADE IN L.A.

LA > < ART

JUNE 2 - SEPTEMBER 2, 2012
SELECTED IMAGES



12. Thomas Lawson. *The Hanged Man*, 2011. Oil on canvas. 72 x 60 in. (182.9 x 152.4 cm). Courtesy the artist and David Kordansky Gallery, Los Angeles.



13. Kathryn Andrews. *Rainbow Successor*, 2011. Stainless steel, rented costume. 73 x 51 x 48 in. (185.4 x 129.5 x 121.9 cm). Ringier Collection, Switzerland. Courtesy the artist and David Kordansky Gallery, Los Angeles. Photo by Brian Forrest.



14. Michele O'Marah. *Character Portrait* (Isabella Blow, Mario Testino version), 2012. Digital photograph. Dimensions variable. Courtesy the artist. Photo by Robert Wedemeyer.